



SHRIKRISHNA

EQUIPMENT

SHRIKRISHNA GROUP
www.rocksplitter.in

HYDRAULIC ROCK & CONCRETE SPLITTER



1. Controlled directional cracking. The required direction of the crack can be obtained by just positioning the handle of the splitter in the direction of the required crack.
2. Much faster and greater output as compared to the conventional Chiseling/Chipping method. As drilling is comparatively easier in Hard rock and the output is directly proportional to the number of holes drilled.
3. Noiseless, Environ - friendly and dust free operation.
4. Single person operation.
5. Due to smooth splitting operation the remaining structure to be saved will be remain intact. Also due to the advantage of control crack direction, we can achieve precise result oriented output.
6. Effectively used in land slide locations.
7. Breaking the bolder to clear the land.
8. Powerful on ground strata.
9. Hydraulic splitter can work under water.
10. Can crack walls, pillars & block.
11. Two splitters can produce up to 900 tons of splitting force.
12. Up to Five splitters can be operate simultaneously on one Power pack.

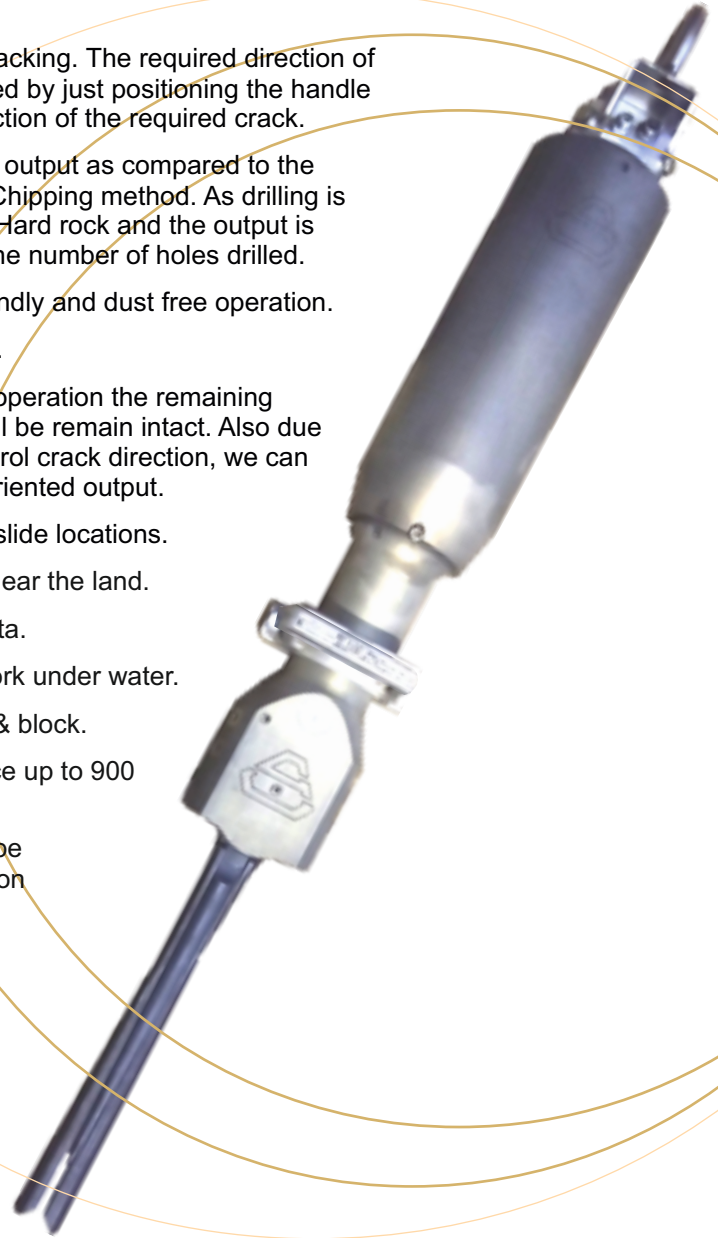

Technical Specification

Model	Types of Wedge set	Drill Hole Dia (mm)	Drill Hole Depth (mm)	Splitting Distance (mm)	Splitting Force(KN/TON) Theoretical	Splitting Force (KN/TON) Actual	Length of Splitter (mm)	Length Wedge Counter Center (mm)		Weight Splitter (Kg)
S-36s	R	32 - 34	320	10	3190 / 319	1650 / 165	800	200	300	16.5
S-36	R	35 – 38	410	15	4525 / 460	2257 / 230	995	250	400	20
S-90	L	45 - 48	580	18 - 55	2995 / 305	1962 / 200	1190	380	600	24
S-240	R	45 - 48	610	20 - 50	6061 / 618	3507 / 358	1290	380	600	31

An only substitute where BLASTING is not allowed

HYDRAULIC POWER PACK



Hydraulic Power Pack

The power pack has got different prime movers (Models)

1. Diesel Engine 2. Petrol Engine 3. Electrical Motor

They are satisfactorily tested in all site conditions. The system is set at an operating pressure of 50 Mpa (500 bar) with the help of pressure regulating valve. Which depending on the power pack model we can operate up to 5 splitters simultaneously.

Hose set

Hose set comprises of high pressure hoses, tested for an operating pressure of 500 Bar connecting multiple splitter distribution block (many folds) is used.

Technical Specification

Model Hyd. Oil	Types of Prime Mover	Rating Kw/Hp	Suitable for Splitter	Weight (kg)	Length (mm)	Height (mm)	Width (mm)	Pump Capacity
7 - DE	Diesel Engine	5.5 / 7.5	1 - 5	115-125	1200	750	700	5.4
10 - DE	Diesel Engine	7.5 / 10	1 - 5	125-150	1200	750	700	5.4
2 - EM	Electric Motor	1.8 / 2.5	1 - 2	40-50	450	400	500	2.0
5 - EM	Electric Motor	4.0 / 5.0	1 - 5	60-70	1200	750	700	4.0
6 - PEH	Petrol Engine	4.5 / 6.0	1 - 3	50-60	600	490	415	2.6
9 - PEH	Petrol Engine	6.75 / 9.0	1 - 5	65-75	1200	750	700	5.4



Diesel Engine



Petrol Engine



Electrical Motor

HYDRAULIC CUTTER



C type Blades can naturally pull the object to the position with the max cut force, it can concentrate the strength and make cutting more efficient. The cutting edge is designed for splash prevention.



Features:

1. High strength light alloy steel blade, lightweight, strong cutting force, high toughness, regrinding possible.
2. The equipment body adopts lightweight high strength aluminum alloy material with ceramic coating on surface, artistic and suitable for underwater operation.
3. C type Blades can naturally pull the object to the position with the max cut force.
4. Cutting more efficient.
5. The manual reversing valve equipped with neutral automatic reset makes operation convenient and more accurate.
6. Adopt bidirectional hydraulic lock, with self - locking function.

Technical Specification

Model	Cutting force(Tons)	Cutting capacity (mm)	Blade opening (mm)	Weight (kg)
SHC -150	38	28	154	14.5

HYDRAULIC SMART ULTRA LARGE ROCK SPLITTER S-1200



Shrikrishna Agro Equipment Pvt. Ltd

are the pioneers in manufacturing small Rock splitters in India. Now for the first time Shrikrishna has come up with ultra large rock splitter to excavate high volume rock excavation without any noise & vibration. The output of S-1200 splitter will be @ 250-300m³ per day. S-1200 splitter can be used for the open trenching foundation excavation.

Tunnel excavation. The splitter can be mounted on crane & normal excavator to excavate open pits, shafts, micro tunneling.

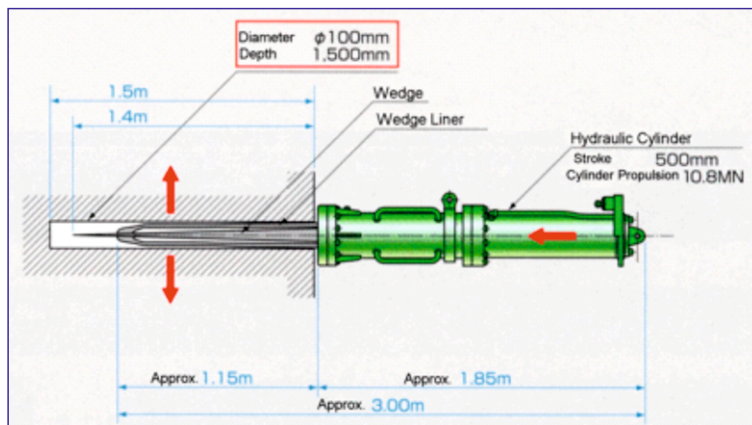
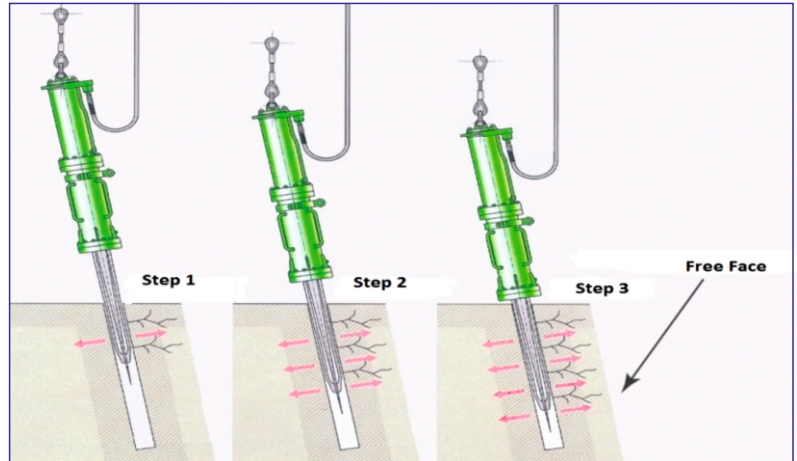

Model	S-1200
Weight	630-670 kg
Drill hole diameter	Ø100mm
Drill hole depth	1,600 -1,800mm
Splitting force	25 KN (2,500 ton)
Splitting distance	20-25 mm
Wedge diameter	Ø95 mm to 110 mm
Wedge length (A)	1,200 mm
Splitter length (B)	3,000 mm
Cylinder length (C)	1,850mm
Hydraulic pressure (min/max)	350/500 bar
Standard split hole spacing	600 x 600 mm

Working of S-1200 Rock splitter:

S-1200 splitter wedge set instered in pre Drilled hole of 100 mm dai & 1800 mm deep.

S-1200 cylinder pushes centre wedge between two counter wedges, which applies a 2500 ton splitting force on side wall of rock hole, resulting in splitting of rock without any noise & vibration.

To obtain maximum output following steps are recommended:

- Step 1: Insert half the total length of wedge & operate the splitter.
- Step 2: Insert about 3/4th of the total length of wedge to split again.
- Step 3: Finally insert the total length of wegde and split to complete.



HYDRAULIC SMART MAGNAPOWER HIGH PERFORMANCE POSITIVE VENTILATION FAN



The ventilation of fire site with high-performance fans by fire brigades. With the help of high-performance fans the temperature is quickly taken care of for a clear view of the emergency services, smoke-free evacuation routes. Shorten search times a faster rescue people and to minimize the risks. Magna power high performance fans perform these functions perfectly in all respects, depending on the application the fan can also be used with water or as a high-expansion foam generator.

- Designed for extreme conditions
- Rapid and uniform smoke extraction
- Rapid improvements in visibility for the Rescue team
- Rapid reduction of the ambient temperature
- Rapid perception of fire and smoke
- Faster detection and rescue of persons



Technical Specification

Model	Air Outlet dia (mm)	Air flow (m³/hr)	Dimensions (wxhxd) (mm)	Weight (kg)	Fuel	Fuel consumption (l/hr)	Power (HP)
SHV-15	400	15000	680x840x500	70	DIESEL	1.5	6.5

HYDRAULIC SPREADER



The function of spreading, tearing, clamping, Pulling etc. Without the need of changing working head. The working head with unique anti-skid design, good anti-skidding performance. The manual reversing valve equipped with neutral automatic reset makes operation convenient and more accurate.



Features:

1. With the function of spreading, tearing, clamping, pulling etc. Without the need of changing working head.
2. The working head with unique anti-skid design, good anti-skidding performance
3. Adopt bidirectional hydraulic lock, with self - locking function
4. The equipment body adopts lightweight high strength aluminum alloy material with ceramic coating on surface, artistic and suitable for underwater operation
5. The handle is easy for left and right hand operation, moving parts have protecting jacket to ensure operator's safety.
6. The spreader head is embedded in the spreader arm with flat structure which can wedge narrow gap to carry out fast rescue.

Technical Specification

Model	Spreading force(Tons)	Max Spreading distance (mm)	Max pulling length (mm)	Max pulling force (Tons)	Weight (kg)
SHS-700	42	740	600	7.4	17

HYDRAULIC CONCRETE CRUSHER



SMART
RESCUE EQUIPMENT

Hydraulic Concrete Crusher can easily demolish concrete up to 200 mm in thickness at a very high working speed.

FEATURES:

1. RESCUE OPERATIONS
2. CONCRETE WALL CRUSHING
3. DEMOLISHING OLD BUILDINGS
4. MINING, INDISPENSABLE IN CASE OF RENOVATION, OLD TOWN CENTERS, URBAN AREAS, HOSPITALS etc.
5. LIGHT WEIGHT, HANDY, PRACTICAL, RELIABLE



Technical Specification

Model	Dimension (lxbxh) (mm)	Weight (kg)	Hydraulic Strength (Tons)	Working Pressure (Bar)	Max Opening (mm)	Crushing Power
SHCC- 230	800x510x215	23	20	700	230	7 Ton

HYDRAULIC DE-WATERING PUMP

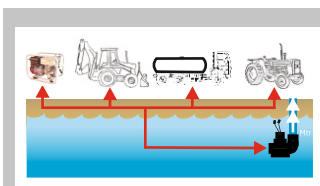

SUBMERSIBLE De-WATERING
PUMP WITH HYDRAULIC MOTOR



SALIENT FEATURES:

1. Implicit Safety
2. Possibility to order the hydraulic motor with integrated valve against excess of flow requirements.
3. Robust, reliable & minimal maintenance
4. Exclusive "closed mono canal" impeller and body in stainless steel
5. Can run dry without problems, zero priming problem
6. Very compact with unbeatable ratio weight / power / size
7. The pumping chamber can be opened in few seconds for inspection and cleaning
8. Can pump very abrasive fluids.

Technical Specification

Model	Dimension HxD (mm)	Outlet Dia (mm)	Weight (kg)	Flow (L/m)	Water Head(mtr)	Oil Flow (L/m)
SHP-80	350 x 370	80 mm	17	1900	35	15-38

HYDRAULIC COMBISHEAR



MULTIPLE USE RESCUE TOOL

SALIENT FEATURES:

1. VERSATILE OPERATIONS
2. EASY TO OPERATE, FAST, PRACTICAL & LIGHT WEIGHT
3. BEST PERFORMANCE
IN - CUTTING, SPREADING, PULLING & SHEARING.

Technical Specification

Model	Weight (kg)	Max Spreading force (Ton)	Max cutting force (Ton)	Working Pressure (Bar)	Max. Blade Opening
SHCT-370	15	23	43	720	370 mm

HYDRAULIC AIR VENTILATOR



Frequently used during Disaster like:

Smoke Extraction & Gas Leak, Sewer Cleaning, Mining, Tunnel work etc.

For fresh air ventilation for working in enclosed area & during disaster for smoke extraction & gas extraction.

Combustion (e.g. – fireplace, gas heater, candle, oil lamp etc.) consumes oxygen while producing carbon dioxide & other unhealthy gases & smoke requiring **air ventilation**.

Technical Specification

AIRVENTILATOR	Technical Data	Dimension (lxbxw)(mm)	Weight (kg)	Power	Fan Material	Inlet Dia (mm)	Air Flow (cm/HR)
HYDRAULIC	SHV 280	600x500x700	21	7 kg/cm ²	POLYPROPYLENE	200	2100
ENGINE DRIVEN	SHV 280 DE	600x500x700	75	3-5 HP	POLYPROPYLENE	200	2100
ELECTRIC MOTOR	SHV 280 EL	600x500x700	45	2-3 HP	POLYPROPYLENE	200	2100

For further information, please contact our distributor

Data, descriptions and pictures are for indication only and absolutely not binding.
The Company reserves the right to modify or improve them without prior notice.



SHRIKRISHNA

AGRO EQUIPMENT PVT. LTD.

S.No 17/1B, Plot No.26, Pragati Industrial Complex,
Kothrud Industrial Estate, Pune- 411 038. M.S. (INDIA)

Phone: +91-20-25433054, 25434328. Mob. 7028064590 Fax: 25469440

E-mail: shrikrishnaequipment123@gmail.com Website: www.rockspiltter.in